

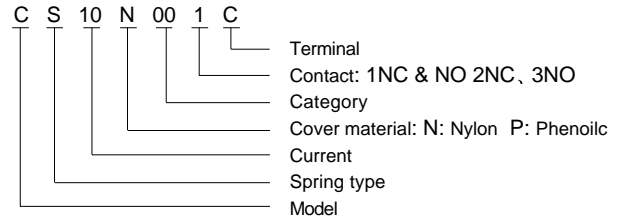

# CS Micro Switch

## Model designations



## Performance

Contact resistance	15 m Ω max. (initial)
Insulation resistance	100m Ω min. (at 500VDC)
Dielectric strength	1,000 VAC 50/60 Hz for 1 minute
Life	Mechanical:10,000,000 operations min. Electrical:100,000 operations min.(full load)

## Appearance and dimension

### CS10N001C2

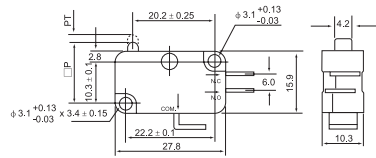

### CS10N011C2

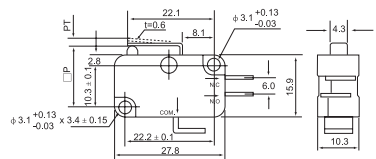

### CS10N031C2

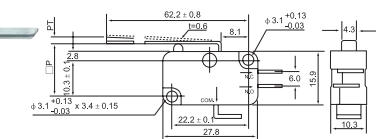

### CS10N051C2

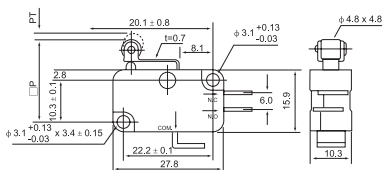

## Outer drawing

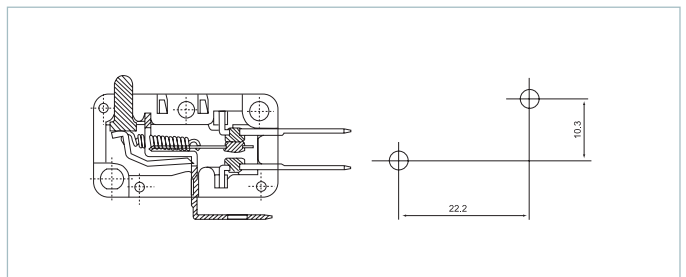

### CS10N021C2

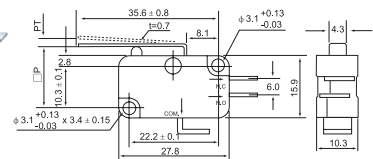

### CS10N041C2

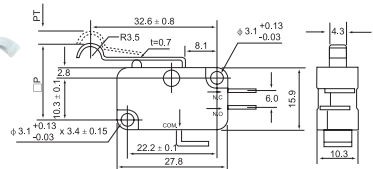

### CS10N061C2

